

- Designed to meet IEEE802.3 & ANSI X3.263 Standards
- Ethernet based LAN, WAN and other networking applications
- LL: 0.5 μ H @ 100KHz, 0.2V
- Cw/w: 25PF TYP @ 100KHz, 0.2V
- Polarity: 1-16, 6-11, In-Phase
- Operating Temperature: -40°C to +85°C
- Halogen Free



Electrical Specifications @ 25°C

Part Number	OCL(μ H Min) @ 100kHz, 0.2V	Turns Ratio chip: cable (\pm 3%)	Insertion Loss (dB Max)	Return Loss (dB Min)			
	With 8mA DC Bias		0.3-100MHz	0.3-30MHz	40MHz	50MHz	60-80MHz
AH1601CI	350	1CT:1CT	-1.1	-18	-16	-14.5	-12

Electrical Specifications @ 25°C

DCR Ω Max	Common Mode Rejection (dB Min)	Cross Talk (dB Min)		HI-POT (Vrms) 60Sec.
	0.5-100MHz	0.5-40MHz	50-100MHz	
1.1	-30	-35	-30	1500

All specifications subject to change without notice.

MECHANICAL

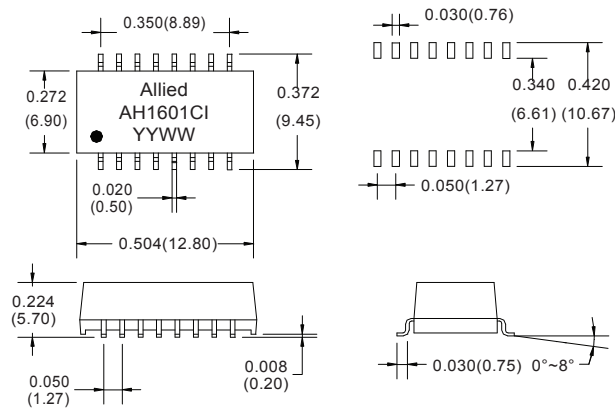

Dimensions:inch(mm)
Unless otherwise specified, all tolerances are \pm 0.010(0.25)

SCHEMATICS

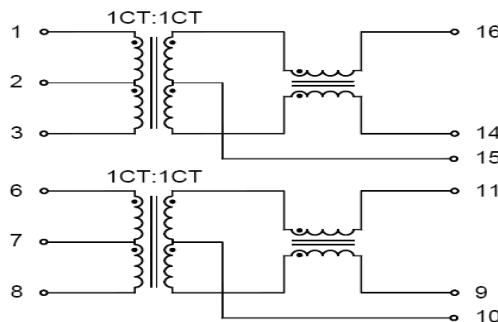

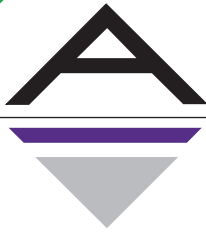

SUGGESTED IR REFLOW

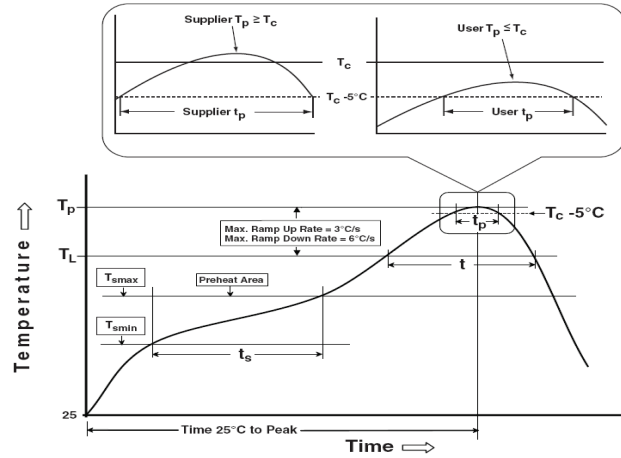

PACKAGING SPECIFICATION

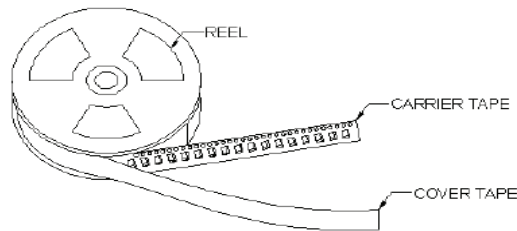

750PCS/REEL
 750PCS/BOX
 4500PCS/CARTON
 N/W: 0.6g/ea

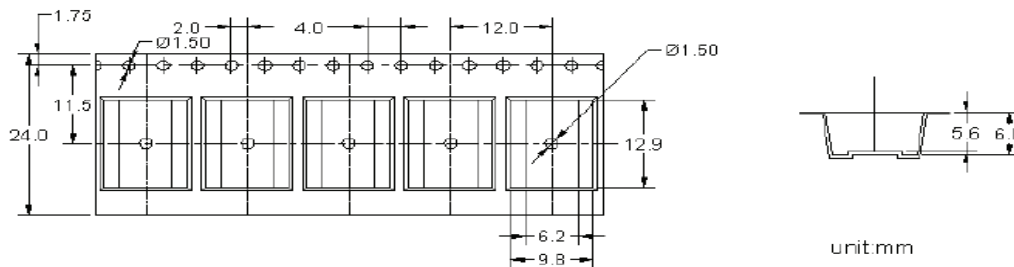
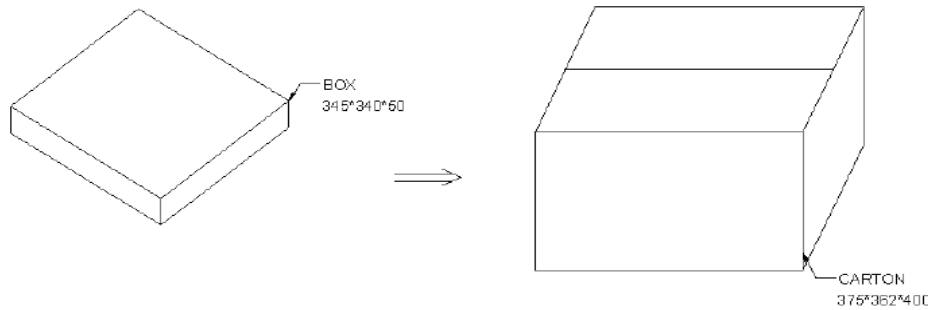

unit:mm



SAMPLE TEST DATA

SPEC \ NO.	1	2	3	4	5
L:(AT100KHz200mV DC8mA)					
350uH MIN					
1-3	567	614	636	598	555
6-8	612	601	543	582	611
LK:(AT 100KHz 200 mV)					
0.5uH Max					
1-3(16-14 short)	0.24	0.22	0.25	0.21	0.24
6-8(9-11short)	0.20	0.23	0.24	0.22	0.25
Cw/w:(AT 100KHz 0.2V)					
32pF Max					
2 TO 15	18	17	19	18	16
7 TO 10	19	18	17	16	18
DCR : (AT 25□)					
1.1Ω Max					
16-14	0.87	0.85	0.86	0.87	0.84
11-9	0.85	0.84	0.85	0.84	0.85
MAIN TEST EQUIPMENT <input type="checkbox"/> YH-150 WITHSTANDING VOLTAGE TESTER <input checked="" type="checkbox"/> CHEN HWA 3250 AUTOMATIC TRANSFORMER TEST SYSTEM <input type="checkbox"/> RF NETWORK ANALYZERS 8712ET					

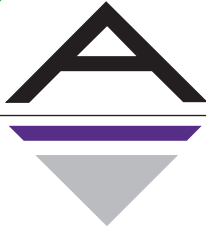

SAMPLE TEST DATA

SPEC \ NO.	1	2	3	4	5
Turns Ratio:					
1-3:16-14=1CT:1CT±5%	OK	OK	OK	OK	OK
6-8:11-9=1CT:1CT±5%	OK	OK	OK	OK	OK
Hi-POT:					
AT:1500VAC					
Pri TO Sec	OK	OK	OK	OK	OK
Insertion Loss:					
-1.1dB Max(0.3-100MHz)					
1-3					
1MHz	0.11	0.10	0.14	0.15	0.13
30MHz	0.20	0.23	0.24	0.21	0.22
40MHz	0.22	0.27	0.27	0.26	0.25
50MHz	0.26	0.32	0.29	0.29	0.30
60MHz	0.29	0.39	0.33	0.36	0.37
80MHz	0.41	0.48	0.45	0.47	0.48
100MHz	0.50	0.57	0.52	0.58	0.58
6-8					
1MHz	0.12	0.11	0.15	0.15	0.12
MAIN TEST EQUIPMENT <ul style="list-style-type: none"> ■ YH-150 WITHSTANDING VOLTAGE TESTER ■ CHEN HWA 3250 AUTOMATIC TRANSFORMER TEST SYSTEM ■ RF NETWORK ANALYZERS 8712ET 					



SAMPLE TEST DATA

SPEC \ NO.	1	2	3	4	5
30MHz	0.21	0.23	0.24	0.20	0.21
40MHz	0.26	0.28	0.27	0.24	0.25
50MHz	0.32	0.37	0.29	0.27	0.28
60MHz	0.35	0.41	0.33	0.32	0.34
80MHz	0.45	0.49	0.45	0.42	0.40
100MHz	0.54	0.62	0.55	0.61	0.51
Return Loss:					
-18dB Min(0.3-30MHz)					
-16dB Min(40MHz)					
-14.5dB Min(50MHz)					
-12dB Min(60-80MHz)					
1-3					
1MHz	26.5	25.6	24.9	27.0	24.5
30MHz	23.0	22.7	22.0	23.8	22.2
40MHz	21.5	21.3	20.8	22.5	20.7
50MHz	18.4	18.2	17.9	19.6	18.0
60MHz	15.5	15.0	14.8	16.1	15.7
80MHz	14.2	13.7	13.5	14.8	14.6
6-8					
1MHz	25.3	26.3	24.4	26.6	25.0
30MHz	22.5	23.2	21.8	23.5	22.2

MAIN TEST EQUIPMENT

- YH-150 WITHSTANDING VOLTAGE TESTER
- CHEN HWA 3250 AUTOMATIC TRANSFORMER TEST SYSTEM
- RF NETWORK ANALYZERS 8712ET



SAMPLE TEST DATA

SPEC \ NO.	1	2	3	4	5
40MHz	21.2	21.8	20.5	21.7	20.7
50MHz	18.0	18.5	17.7	18.3	18.0
60MHz	15.3	15.7	14.6	15.5	15.1
80MHz	14.0	14.5	13.6	14.4	13.8
Cross Talk:					
-35dB Min (0.3-40MHz)					
-30dB Min (50-100MHz)					
TX TO RX					
30MHz	58.8	59.0	57.2	58.3	57.8
60MHz	52.6	54.4	51.9	50.6	52.1
100MHz	46.0	47.2	45.1	44.4	44.0

MAIN TEST EQUIPMENT

- YH-150 WITHSTANDING VOLTAGE TESTER
- CHEN HWA 3250 AUTOMATIC TRANSFORMER TEST SYSTEM
- RF NETWORK ANALYZERS 8712ET