

Turonic ST3

Steam mop



USER'S MANUAL

Please read this manual before using the product



**THANK YOU
FOR CHOOSING TURONIC ST3!**

TURONIC ST3 is a high-power steam mop that will help you to keep your entire home clean.

WHAT'S IN THE BOX

1. Steam mop
2. Handle extension
3. Handle
4. Head
5. Carpet glider
6. Two spare microfiber cloths
7. User's manual
8. Accessories set

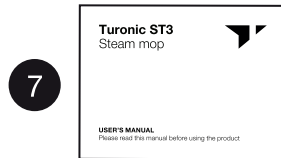
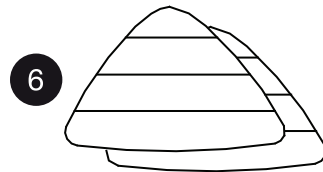
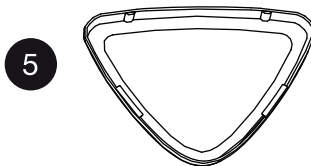
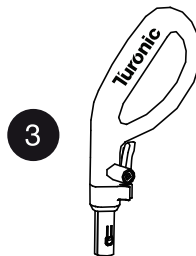
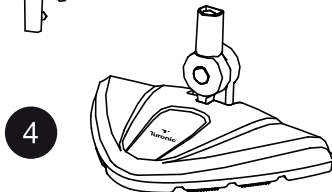
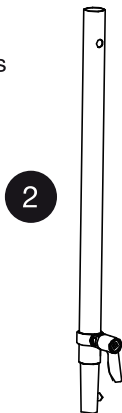
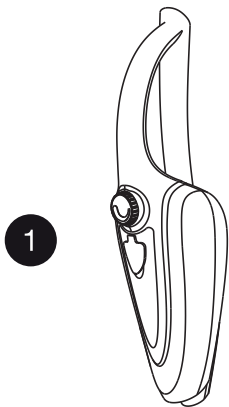

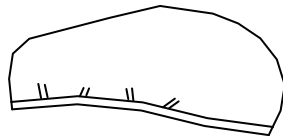
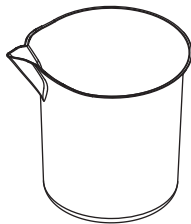
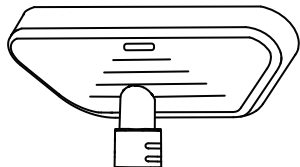
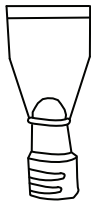
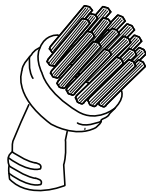
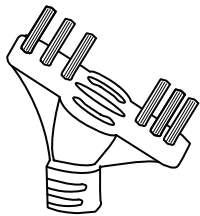
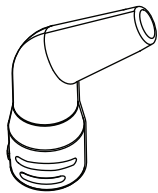

HOW TO ASSEMBLE

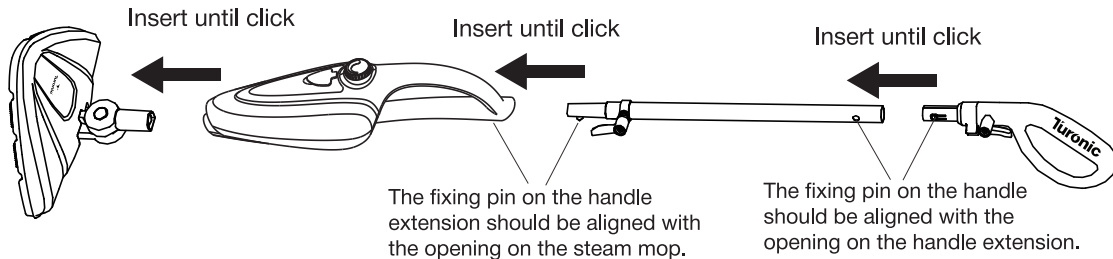

HOW TO DISASSEMBLE

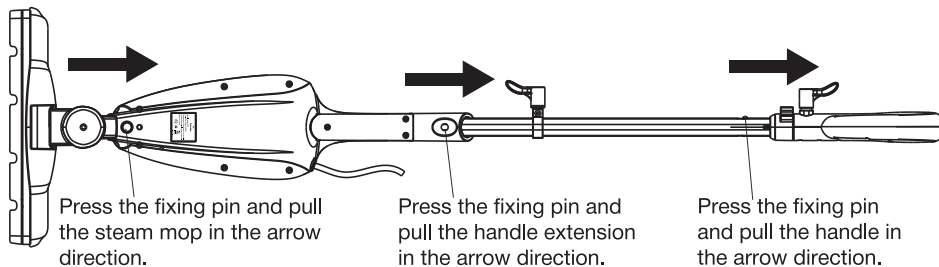

PARTS AND CONTROLS

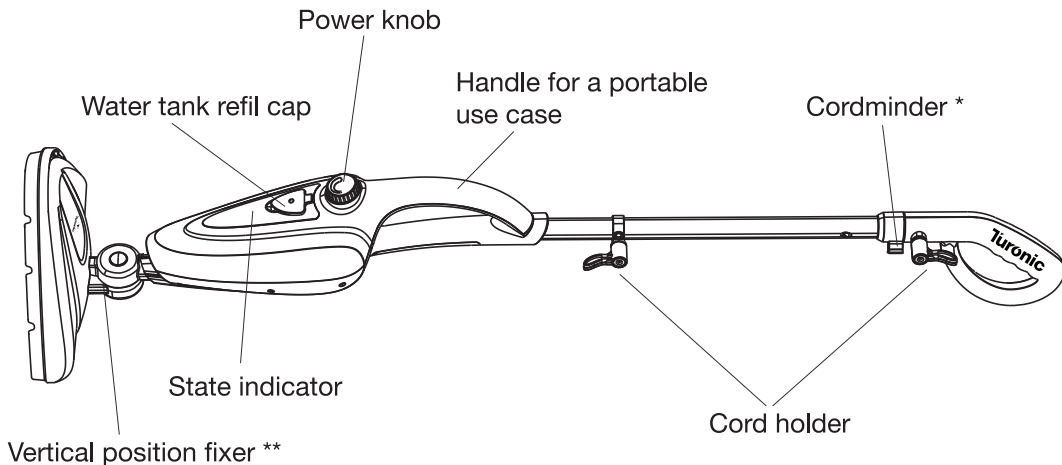

- * The cordminder is used to fix the power cable so that it does not bother you when using the mop as the power cable is 7 meters long.
- ** To release the vertical position fixer, when the steam mop is standing on the floor, pull the mop towards you using the handle. Now the head can swivel freely repeating all the corners of the room. To fix the vertical position back, when the steam mop is standing on the floor, push the mop frontwards using the handle.

ATTACHMENTS

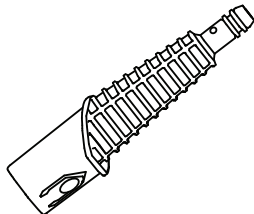

STEAMER JET

Should be used for the hard-to-reach areas such as around the faucet, around the stove top and so on.

Also serves as an adapter for the other attachments.

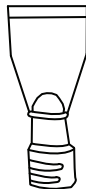

SCRAPING TOOL

Should be used for scraping off the food residues and grease and other substances from the flat surfaces.

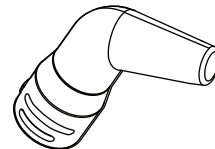

CURVED NOZZLE

Should be used for the hard-to-reach areas such as around the faucet, around the stove top, for the sink cleaning and so on.

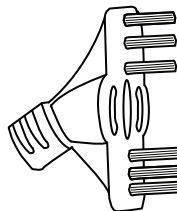

GROUT CLEANING BRUSH

Should be used for cleaning the grout lines, sanded or non-sanded.

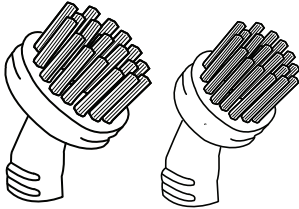

BIG AND SMALL SCRUB BRUSHES

Should be used for cleaning the ovens, microwaves, stove tops, bathtubs, faucet fixtures, refrigerators and so on. The size depends on application.

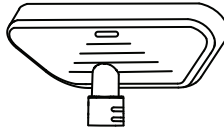

WINDOW SQUEEGEE

Should be used for cleaning the windows, mirrors and other glass surfaces.



GARMENT STEAMER CLOTH

Should be used for cleaning the draperies, tablecloths and other fabric products.

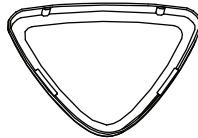

CARPET GLIDER

Should be used for cleaning the carpets.
The glider is attached directly to the steam mop head.

HOW TO INSTALL THE CLOTH

1. Align the velcros on the cloth with the velcros on the head per the picture.
2. Evenly attach the cloth to the head flattening all the curves.
3. To remove the cloth, gently tear it off from the head.

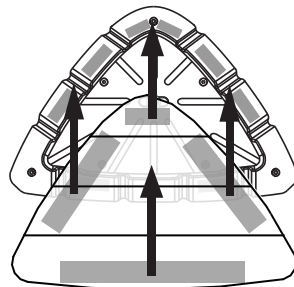

HOW TO INSTALL THE CARPET GLIDE

1. Align the head with the carpet glide.
2. Attach the carpet glide to the head per the picture.
3. To remove the carpet glide, gently pull it from the head.

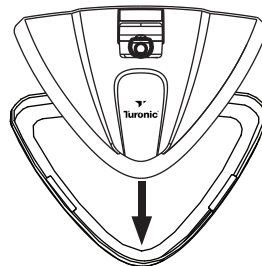

HOW TO INSTALL THE ATTACHMENTS

1. Remove the head if it has been installed.
2. Install the steamer jet which also serves as an attachment adapter per the picture.
3. Install the required attachment onto the steamer jet tip and twist it counterclockwise.
4. To remove the attachment, twist it clockwise on the tip.
5. The steamer jet removal procedure is similar to the head removal.

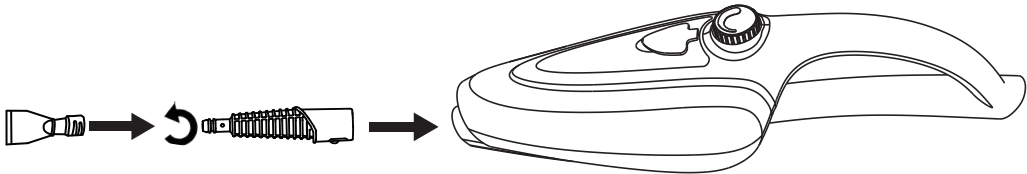

HOW TO USE



WARNING: DANGER OF SCALDING!

Beware of steam when operating the unit. The steam is hot and may cause severe burns if it comes in contact with bare skin. Never run the steam mop without water. Never direct steam at any person or animal.

Use as a steam mop

1. Assemble the steam mop by installing the handle, handle extension, head and cleaning cloth.
2. Open the tank cap and fill the tank to approximately 95% using the supplied cup (about one and a half cup). Firmly close the tank cap.
3. Connect the power plug to the power source.
4. Rotate the power knob clockwise until you hear the click to turn on the device.
5. Set the required steam generation power by keeping rotating the power knob. The lower setting is, the less amount of steam will be generated.
6. You will see the red state indication meaning that the pre-heating process has started. The preheating process takes about 15 seconds.
7. When the pre-heating finished, the red state indication will turn blue, the water pump will start working and the steam will start being generated. The pump is the only part that is making a noise, so no worries, all is working fine.
8. One full tank can provide up to 17 minutes of continuous steam generation. When the water level in the water tank is low, turn off the steam mop immediately. To refill the tank, turn off the steam mop by rotating the power knob counterclockwise until you hear the click and the state indication goes off, unplug the power cable from the power source, open the tank cap a add some water, then close the cap back.

Use as a hand-held steamer

1. Remove the handle, handle extension and head with cleaning cloth, if were installed.
2. Inatall the steamer jet that also serves as the attachment adapter.
3. Install the required attachment.
4. Open the tank cap and fill the tank to approximately 95% using the supplied cup (about one and a half cup). Firmly close the tank cap.
5. Connect the power plug to the power source.
6. Rotate the power knob clockwise until you hear the click to turn on the device.
7. Set the required steam generation power by keeping rotating the power knob. The lower setting is, the less amount of steam will be generated.
8. You will see the red state indication meaning that the pre-heating process has started. The preheating process takes about 15 seconds.
9. When the pre-heating finished, the red state indication will turn blue, the water pump will start working and the steam will start being generated. The pump is the only part that is making a noise, so no worries, all is working fine.
10. One full tank can provide up to 17 minutes of continuous steam generation. When the water level in the water tank is low, turn off the steam mop immediately. To refill the tank, turn off the steam mop by rotating the power knob counterclockwise until you hear the click and the state indication goes off, unplug the power cable from the power source, open the tank cap a add some water, then close the cap back.



Do not use the steam mop on unsealed wood floors. Take extra care when using the steam mop on surfaces that have been treated with wax, as the heat and steam may remove it. Also, take extra care when using the steam mop on vinyl, linoleum or any other heat-sensitive floors, as too much heat can melt the glue on the floor.

HOW TO CLEAN



Before cleaning the steam mop:

- 1) Ensure that it is disconnected from the power source and cooled down.
- 2) Drain any remaining water from the base every time you finish with steaming.

Decalcification of the water tank interior

1. Fill the water tank to approximately 50% using the supplied cup.
2. Add two tablespoons of white vinegar into the tank, close the tank cap and shake the steam mop well.
3. Fill the tank to about 95%.
4. Let it sit like this for a few hours.
5. Empty the tank and refill with clean water several times until the tank is clean.

Removing the lime scale from the device

If you notice that the steam mop produces less steam than before or stops producing steam at all, you may need to remove the lime scale. The lime scale can develop over time on the metal parts of the mop and greatly affect the mop performance. It is necessary to remove lime scale on the regular basis every 50 uses, especially in areas with hard water.

1. Fill the water tank with 1/3 of white vinegar and 2/3 of tap water.
2. Position and secure the unit in a way that the generated steam is aimed away from the floor or any surrounding objects and surfaces.
3. Connect the steam mop to the power source and turn it on at the maximum power.
4. Allow the device to produce the steam until the tank is empty.
5. Repeat the steps until the usual amount of generated steam is restored.
6. Refill the tank with clean water and let the device to produce the steam until the tank is empty.



Do not leave the steam mop unattended during the lime scale removal procedure.

Cleaning the blocked attachment

Usually, all the attachments can be hand-washed using hot soapy water, however, if you notice that the attachment opening is blocked, perform the following steps:

1. Apply a small amount of sprayed lubricant (such as WD-40) inside the steamer jet attachment.
2. Install the steamer jet attachment onto the steam mop.
3. Install the blocked attachment onto the steamer jet.
4. Make sure that the water tank is filled to at least 50%.
5. Turn on the steam mop and set it to maximum power.
6. Allow the device to produce the steam through the affected attachment for a couple of minutes.
7. Hand-wash the steamer jet and cleaned attachment using hot soapy water.

Cleaning the microfiber cloth

The microfiber cloths are machine washable. Always use a mild detergent and avoid fabric softeners. Air dry only.



Never use bleach or fabric softener when cleaning the microfiber cloths.

HOW TO STORE

Ensure the steam mop is completely cool and dry before storage.

Keep the appliance in a cool, dry place.

Do not let the steam mop stand on any wood floor for an extended period of time. This could cause the wood grain to expand.

Remove the cleaning pad and wash it so that it will be ready for next use.

TROUBLESHOOTING

If the steam mop does not run smoothly, please check out the following guidelines.

Problem	Possible reasons	Solutions
Steam mop does not turn on	The steam mop is not connected to the power source. There is no power in the building.	Connect the steam mop to the power source. Check if there is a power in the building. If no, wait until it is restored.
Reduced amount of steam or no steam at all	Water tank is empty. Lime scale deposition. The steam mop is turned off. Nozzle on the steam mop or on the steamer jet attachment is blocked.	Refill the water tank. Clean the steam mop following the steps from the «Removing the lime scale from the device» section. Turn on the steam mop. Clean the nozzle on the bottom of the steam mop (where the head is connected) or on the steamer jet attachment.
Abnormal noise during operation	Water tank is empty.	Refill the water tank.

SAFETY RULES



To reduce the risk of fire, injury or electrical shock along with extending the life of your device, please read and follow all of the information in this manual before using and save it for future reference.

Before connecting the device to the power source, check if the voltage indicated on the rating label corresponds to the mains voltage in the building.

The device must be used only for its intended purpose. Incorrect operation and improper use can damage the device and cause injury to the user. The manufacturer and seller bare no responsibility for any damage caused by incorrect use or improper handling.

This device can be used by persons with reduced physical, sensory or mental capabilities or lack of experience and knowledge under supervision or if they have been given the instructions on how to use the device in a safe way and if they understand the hazards involved.

This device shall not be used by children. Cleaning and maintenance must not be carried out by children. Keep the device out of reach of children when it is operating or cooling down. Close supervision is necessary when the device is used near children.

This device is not a toy, do not let small children to play with it. In order to ensure your children's safety, please keep all packaging materials out of their reach. Do not allow small children to play with the foil. There is a danger of suffocation.

The device shall not be left unattended while it is plugged into the outlet.

The device must not be used if it malfunctions, if there are visible signs of damage, or if it is leaking.

Never use the device if the cord shows any signs of damage. Do not attempt to repair or modify the device in anyway.

This device is intended for a household use only.

Never immerse the device in water or any other liquid for any reason whatsoever. Never place it into the dishwasher. Never use this device near spray fountain. Never use this device with wet hands. Make sure the power cord and plug never come into contact with water or other liquids. If the device is wet, immediately unplug the device from the outlet and wipe it dry.

Do not use the device near hot surfaces or in contact with any flammable materials. Ensure that the power cord does not come into contact with hot parts of this device.

Unplug the device from the electrical outlet before replacing any accessory parts, cleaning, refilling the water tank, or when it is not in use.

Never use the device outdoors and always place it in a dry environment.

Never use accessories which are not recommended by the producer. They could constitute a danger to the user and risk to damage the device.

Make sure the cord cannot get caught in any way to avoid the chance of tripping over or becoming entangled in the cord.

Make sure the device has cooled down before cleaning and storage.

The temperature of accessible surfaces is high when the device is operating. Never touch these parts to avoid scalding.

This device is not intended to be operated by means of an external timer or separate remote-control system.

The device must be used and rested on a flat and stable surface. Do not cover the device with anything.

If a longer detachable power-supply cord or extension cord is used, the marked electrical rating of the cord set or extension cord should be at least as great as the electrical rating of the device.

FCC STATEMENT

FCC Compliance Statement - Part 15

This device complies with Part 15 of the FCC Rules. Operation is subject to the following two conditions:

1. This device may not cause harmful interference, and
2. This device must accept any interference received, including interference that may cause undesired operation.

Any changes or modifications not expressly approved by the party responsible for compliance could void the user's authority to operate the equipment.

FCC Interference Statement - Part 15

This equipment has been tested and found to comply with the limits for a Class B digital device, pursuant to Part 15 of the FCC Rules. These limits are designed to provide reasonable protection against harmful interference in a residential installation. This equipment generates, uses and can radiate radio frequency energy and, if not installed and used in accordance with the instructions, may cause harmful interference to radio communications. However, there is no guarantee that interference will not occur in a particular installation. If this equipment does cause harmful interference to radio or television reception, which can be determined by turning the equipment off and on, the user is encouraged to try to correct the interference by one of the following measures:

- Reorient or relocate the receiving antenna.
- Increase the separation between the equipment and receiver.
- Consult the dealer or an experienced radio/TV technician for help.

RF Exposure Information

This equipment complies with FCC radiation exposure limits set forth for an uncontrolled environment. In order to avoid the possibility of exceeding the FCC radio frequency exposure limits, human proximity to the antenna shall not be less than 20cm during normal operation.

SPECIFICATIONS

Power 1500W

Rated voltage 110-120V

Frequency 60Hz

Tank capacity 385ml / 0.1gal / 23.5in³

Cord length 7m / 275in / 23ft

Weight 4kg / 8.81lbs

RECYCLING

Steam mops can be recycled, and they should be in order to keep our planet clean.
Where should you bring them?

In the US, there are a couple of options:

**<https://call2recycle.org>, <https://search.earth911.com>, <https://recyclenation.com/find>,
<https://cta.tech/Consumer-Resources/Greener-Gadgets>**

In Canada, please visit the links below for help:

<https://thinkreuse.net>, <https://all2recycle.ca>

In the UK, please visit the links below for help:

<https://recycle-more.co.uk>, <https://recyclenow.com/local-recycling>

THANK YOU!

We truly appreciate that you chose TURONIC as your trusted brand of steam mop and sincerely hope you enjoy the great efficiency and seamless usability that the TURONIC ST3 provides. We love making our customers happy by providing true value with our products. If for any reason you are not completely satisfied with your purchase or have any questions, please contact us via support@turistic.com. We care about our customers most of all and are always here to serve you.

1 YEAR WARRANTY

Parts and Labor Warranty

Please visit turonic.com

To register YOUR product.

Designed by Productech in the U.S.

Turonic[®]

ST3
Steam Mop

Made in China



WARNING: This product can expose you to Bisphenol A, which is known to the State of California to cause cancer. For more information, go to www.P65Warnings.ca.gov

