



TREBLAB

# X-Smart

## User's Manual

Please read this manual  
before using the product



# Thank you for choosing the TREBLAB X-Smart!

Our earbuds provide superior sound quality and exceptional AI translation features (support of 100+ languages). Before using the product, please read this manual.

## WHAT'S IN THE BOX

1.



2.



3.



4.



5.



6.



7.

8.



**X-Smart**

1. TREBLAB X-Smart earbuds

2. Charging case

3. TREBLAB logo sticker

4. User's manual & quick start guide

5. Charging cable

6. Spare eartips

7. Neckband

8. Cleaning brush

## BUTTONS AND PARTS

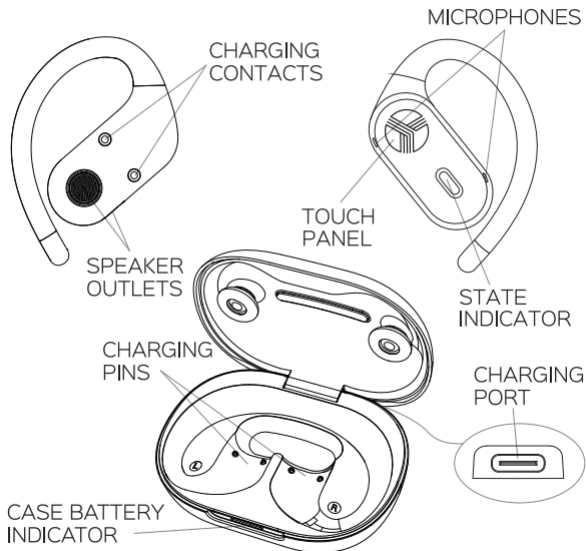

<b>Function</b>	<b>Operation</b>
Power on	Take the earbuds out of the case or touch the <b>Touch panels</b> of both earbuds and hold for 3 seconds.
Power off	Put the earbuds back into the case and close it or touch the <b>Touch panels</b> of both earbuds and hold for 5 seconds when no media is played.
Pause / Play	Touch either earbud's <b>Touch panel</b> twice.
Next track	Triple-touch the right earbud's <b>Touch panel</b> .
Previous track	Triple-touch the left earbud's <b>Touch panel</b> .
Gaming mode	Touch the right earbud's <b>Touch panel</b> for 4 times.
Volume +	Touch the right earbud's <b>Touch panel</b> once with 1-second intervals.
Volume -	Touch the left earbud's <b>Touch panel</b> once with 1-second intervals.

Answer a phone call	Double-touch either earbud's <b>Touch panel</b> during the incoming call.
Reject a phone call	Touch either earbud's <b>Touch panel</b> and hold for 2 seconds during the incoming call.
Hang up	Double-touch either earbud's <b>Touch panel</b> when on a call.
Voice assistant activation	Touch the right earbud's <b>Touch panel</b> four times.
Disconnect	Touch both earbud's <b>Touch panel</b> five times when the earbuds <b>are connected</b> to the source device.
Factory reset	Touch both earbud's <b>Touch panel</b> five times when the earbuds <b>are not connected</b> to the source device.

## HOW TO ENSURE A PROPER FIT

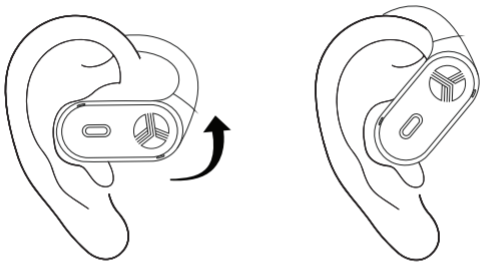

To get the best possible fit with your **X-Smart** earbuds, put the earbuds onto your ears and twist them the way so that the main speaker outlet (the one with a silicone eartip) is aligned with your ear canal. With a proper fit, you'll notice more range when listening to music.

## CHARGING

There are three things to keep in mind:

1. The X-Smart's case is not compatible with 90W+ chargers.
2. The X-Smart model comes with protective stickers on the charging contacts of each earbud. Remove these stickers prior to charging the earbuds.
3. After use and before charging, wipe the earbuds carefully to remove any moisture from the charging contacts.

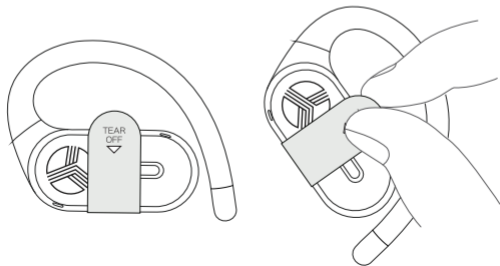

## **To charge the case**

The supplied charging case is equipped with a rechargeable battery capable to recharge the earbuds from 0% to 100% 5 times.

When the case battery level is low, you will see the green battery indicator blinking.

To charge the case, connect one side of the supplied charging cable into the USB Type-C charging port (on the back of the case) and the other side into a power source. While charging, the white battery indicator will be blinking. Once fully charged, you will see the steady white light. It takes about 2 hours to fully charge the case.

Be sure to use a 5V DC, 0.5 - 2A adapter or charger. Using a power source with lower power will increase the overall charge time.

## To charge the earbuds with the charging case

When the earbuds' battery is running low, you will hear the sound prompt (similar to a busy tone).

Put the left and right earbuds into the slots in the charging case. The earbuds will turn off automatically. The case will immediately start charging the earbuds. You will see the red state indicators on the earbuds. When the earbuds are fully charged, the red state indicators will go off. It takes about 1.5 hours to charge the earbuds.

## SETTING UP YOUR EARBUDS

### To turn the earbuds on

1. Take the earbuds out of the case, the earbuds will turn on automatically.
2. Another option to turn them on is to touch the **Touch panels** of both earbuds and hold for 3 seconds. You will hear several sound prompts indicating that the earbuds are turned on and ready for pairing. The green state indicators will light up on both earbuds and, a few seconds later, the state indicator will start flashing green on one of the earbuds.

3. You will hear another sound prompt after connecting to the device.

### **To turn the earbuds off**

1. Put both earbuds into the slots in the charging case.
2. Alternatively, touch the **Touch panels** of both earbuds and hold for 5 seconds when there is no media played. You will hear the sound prompt indicating that the earbuds are being turned off. The green state indicator will light up for 1 second and go off on both earbuds.

## **PAIRING**

You can pair the **X-Smart** earbuds with your device either together or separately. Using only one earbud at a time will help you to extend the overall playtime. Please read the instructions below to make the pairing process smooth and easy.

### **To pair both earbuds**

1. Open the case lid and take the earbuds out of the case. The green state indicators will light up on both earbuds and, a few seconds later, the state indicator will start flashing green on one of the earbuds.

2. Activate the wireless communication function on your smart device, scan/search for **TREBLAB X-Smart**, and click CONNECT. Make sure to select the media device and not the one required for the APP.



3. If prompted by your device to connect, select Yes.
4. You will hear the sound prompt indicating that the earbuds are connected. The green state indicator will become steady.

When you turn the earbuds on, they will try to reconnect with the recently connected device. If the reconnection does not happen automatically, the earbuds will try to find the next device in the pairing list. You can only connect and play audio from one device at a time. But you can save up to 6 connected devices in the pairing list.

**NOTE:** The earbud, which state indicator is flashing green during pairing, is the main one. For better performance, keep your smart device closer to the main earbud.

## To pair one earbud only

1. Take one earbud out from the charging case. The state indicator should start flashing green, indicating that it is in the pairing mode.
2. Activate the wireless communication function on your smart device, scan/search for **TREBLAB X-Smart**, and click CONNECT.
3. If prompted by your device to connect, select Yes.
4. You will hear the sound prompt indicating that the earbud is connected. The green state indicator will become steady.

## AUDIO PLAYBACK

To pause and resume the playback, double-touch either earbud's **Touch panel**.

To change tracks on **X-Smart**, triple-touch the right earbud's **Touch panel** to play the next track and triple-touch the left earbud's **Touch panel** to play the previous track.

To adjust the volume, touch the right earbud's **Touch panel** with one-second intervals to increase the volume and touch the left earbud's **Touch panel** with one-second intervals to decrease the volume.

## PHONE CALLS MANAGEMENT

The **TREBLAB X-Smart** can be used to make and receive calls when connected wireless. Audio playback will be paused during the calls.

**To answer a call:** Double-touch either earbud's **Touch panel** during an incoming call.

**To reject a call:** Touch either earbud's **Touch panel** and hold for 2 seconds during an incoming call.

**To end a call:** Double-touch either earbud's **Touch panel** when on a call.

## GAMING MODE

**TREBLAB X-Smart** earbuds support the gaming mode to reduce the audio latency up to 50ms. This allows to achieve better video/audio synchronization and improve your gaming and video watching experience.

1. To enable the gaming mode, touch the **Touch panel** four times on left earbud. You will hear the ascending sound prompt and feel the lower latency while gaming/watching videos.

2. To disable the gaming mode, touch the **Touch panel** four times on left earbud again. You will hear the descending sound prompt and the latency will go back to the standard 200ms.

**NOTE** In the gaming mode, the connection range is much shorter than in standard one, so, if you are experiencing some connection issues or drops, please make sure to disable the gaming mode.

## **VOICE ASSISTANTS SUPPORT**

**TREBLAB X-Smart** earbuds are compatible with most of the voice assistants. To use a voice assistant, touch the right earbud's **Touch panel** for times.

## **RESET TO THE FACTORY SETTINGS**

You can reset the **X-Smart** earbuds to the factory default settings by cleaning up the pairing list with the last 6 devices previously connected to **X-Smart**.

Make sure that the earbuds are disconnected from the source device. Touch both earbuds' **Touch panel** five times. You will hear the «du-du» sound prompt.

The earbuds' memory has been returned to the factory settings.

## **APP FOR AI TRANSLATION AND MANY MORE**

1. When the earbuds are connected to the smart device, download the APP by scanning the QR code below and selecting the respective operating system or simply search for the Earjoy APP in the Play Market/Apple Store.



2. Open the APP, agree with the Privacy Policy and User Agreement (1), and register (2) a new account or login (3) if you already have one.

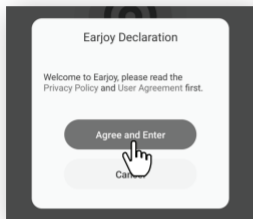

1

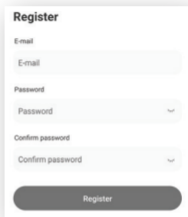

2

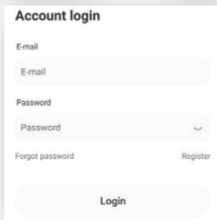

3

3. Once logged in, you can look through the Quick Start Guide of the AI functions by pressing NEXT STEP (1) or close the screen by pressing GOT IT (2).

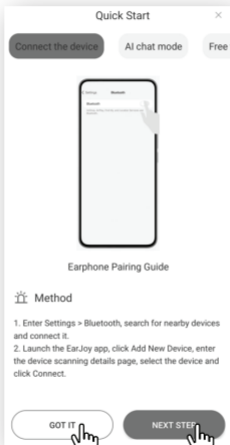

2

1

4. After the Quick Start Guide is closed, on the next screen select Add New Device (1), grant the Nearby devices (2) and Location (3) permissions and select **TREBLAB X-Smart** (4).



1



2

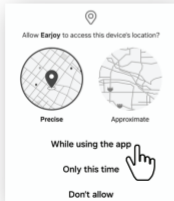

3

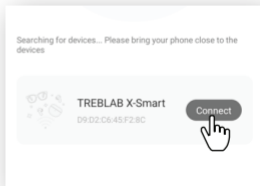

4

## HOME SCREEN

When the earbuds are successfully connected, you will see the Home screen. On this screen, you can see the earbuds' battery level (1), volume level (2), find earbuds (3), adjust the sound equalizer (4) or change the touch functions (5).

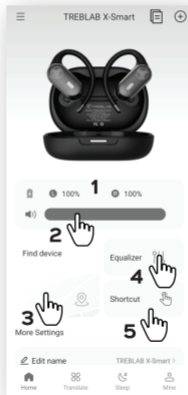

## EQ settings

Here you can select from the provided 8 presets (1) or manually (2) adjust the equalizer.



## Touch functions mapping

Here you can adjust what single, double and triple touches will do when you touch the **Touch Panels**.

single click	
Left	Volume Down >
Right	Volume Up >
double click	
Left	Play/Pause >
Right	Play/Pause >
three click	
Left	Previous Track >
Right	Next Track >
long click	
Left	None >
Right	None >

## TRANSLATE TAB

Switch to the Translate tab and select the function you want to use.

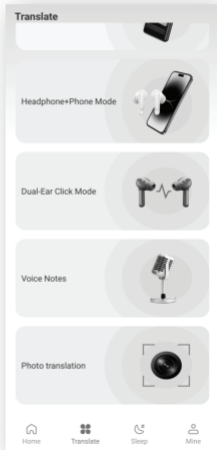

## AI chat mode

This feature allows you to ask AI some questions and it will reply. Before to proceed, make sure to grant Microphone permission (1) to the APP and select the required language (2) from 9 available (3). Now you can ask AI using voice input (4) or keyboard (4).

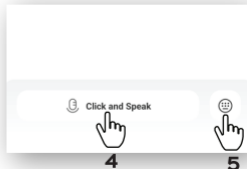
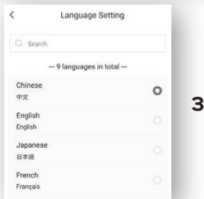
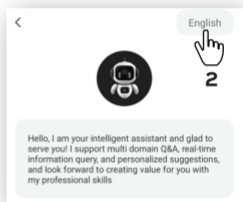
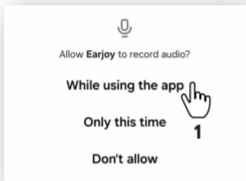

## Free talk mode

This feature allows you to communicate with another person in real life. Just select the required language couple (1 & 2), keep one earbud and give another one to another person, press Click and Speak (3) and start your conversation.



Click the button to start the conversation

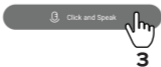

## Translation machine mode

This feature allows you to communicate without using the earbuds. Just select the required language couple (1 & 2), and press the required button (3 & 4), depending on what language you are going to speak.

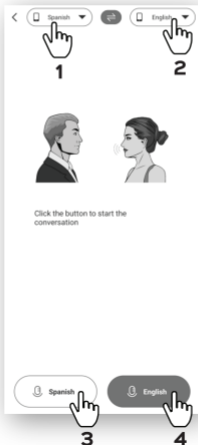

## Headphone + phone mode

This feature allows you to communicate using phone and earbuds. Just select the required language couple (1 is for the phone and 2 is for the earbud), give the earbuds to another person, press the button with the selected language name (3) and start your conversation. When another person wants to reply in another language, they need to touch the **Touch panel** once.



## Dual-ear click mode

This feature allows you to communicate using both earbuds. Just select the required language couple (1 is for the left earbud and 2 is for the right earbud), keep one earbud and give another one to another person, touch the **Touch panel** once and start your conversation. When another person wants to reply in another language, they need to touch the **Touch panel** once as well.

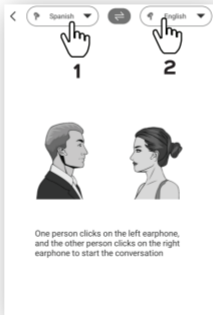

## Voice notes

This feature allows you to make and transcribe the voice notes. Just press the Recording button (1), select the language you will speak (2) and enter the recording name (optional) (3), and start recording (4). You will see the text appearing on the screen (5). To delete the note, long-touch it and select Delete (6).

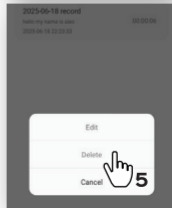
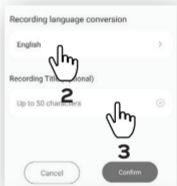
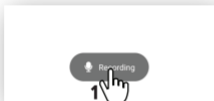

## Photo translation

This feature allows you to translate the text from newly taken pictures or the pictures from the gallery. Just select the required language couple (1 & 2) and take a picture (3) or select from the gallery (4).

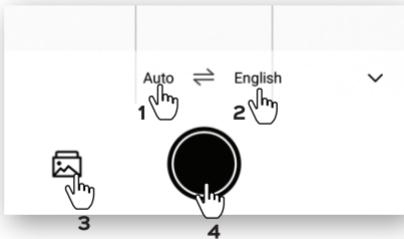

## SLEEP TAB

The **TREBLAB X-Smart** earbuds can produce selected white noises during your sleep. Just switch to the Sleep tab and select the required sound effect.

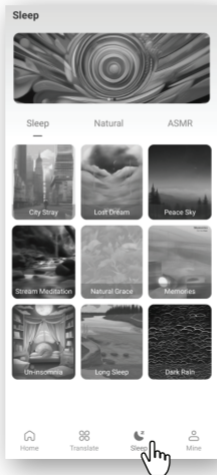

## MINE TAB

On this tab you can change the APP theme color (1) or select different interface language (2).

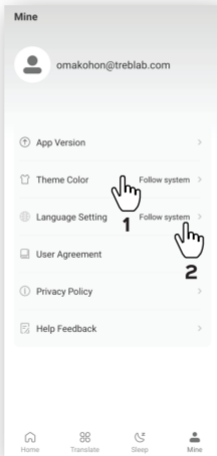

## CLEANING

It is recommended to clean the earbuds once every two weeks as dust can accumulate and clog the speaker protective screens located on the side and on the bottom of the earbuds.

To clean the earbuds, you will need two things:

- Eyelash brush or alike
- Alcohol

1. Soak the eyelash brush (or alike) into the alcohol.
2. Clean the protective screens on the side and bottom of the earbuds with forward and backward movement.

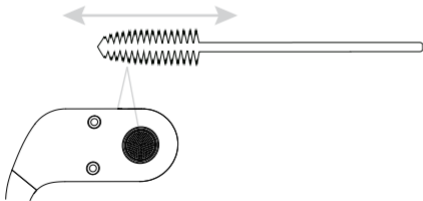

3. Let the earbuds dry before repeated use.

## TROUBLESHOOTING

### **Problem**

### **Solution**

**Can't turn the earbuds on**

Please make sure the earbuds are charged, if not – charge them and try again.

**Earbuds do not charge**

Please check if there is a protective tape on the charging contacts of both earbuds. If yes, please remove it and try to charge the earbuds once again.

Clean the charging contacts on the earbuds with a slightly damp cotton swab when they are turned off (we recommend using alcohol or a specially designed cleaning fluid sold for electronics).

Check if the earbud slots in the charging case are free of debris.

Try charging the case with another Type-C cable, power source, adaptor (if available).

**Device  
doesn't find  
TREBLAB  
X-Smart**

Make sure the **X-Smart** buds are not paired with any other device, as they can pair only with one device at a time.

If **X-Smart** are in pairing mode and one of the earbuds flashes green, but still is not found by your device, please restart your device and the headset.

Reset your earbuds to the factory settings by following the steps from the section "RESET TO THE FACTORY SETTINGS". Try to pair again.

**Frequent  
disconnection  
and noise**

Make sure that the distance between your device and the earbuds is less than 33 feet / 10 meters.

Make sure that nothing is blocking the signal between your device and your **X-Smart** earbuds.

If the earbuds are on, but disconnected from the device for longer than 15 minutes, they will automatically turn off to save power.

## Can't connect the earbuds to the device

Make sure that you are connecting to the media device and not the one required for the APP operation



Make sure the **X-Smart** earbuds are not paired with any other device, as they can pair only with one device at a time.

Make sure that the distance between your device and the headphones is less than 30 feet/10 meters.

Reset your earbuds to the factory settings by following the steps from the section “RESET TO THE FACTORY SETTINGS”. Try to pair again.

## Mobile APP is not working properly

Make sure that you granted all the required permissions to the APP (Microphone, Nearby devices, Location and so on). If not, please grant.

Make sure that you have a stable internet connection as the APP needs the internet access to work.

## SAFETY RULES

- Never disassemble or modify your **X-Smart** for any reason. Doing this may cause the earbuds to malfunction or even become combustible. The damage to your earbuds can void your manufacturer's warranty.
- Do not charge the earbuds when they are wet. Make sure to dry off the earbuds before charging.
- Avoid exposing the **TREBLAB X-Smart** to extreme temperatures (below 37°F / 3°C or above 112°F / 45°C). Extreme temperatures can deform the components inside the **X-Smart**, reducing the battery life and the lifespan of your new earbuds.
- Avoid putting the device's LED lights close to the eyes of children or animals.
- Do not use your **X-Smart** during a thunderstorm. Thunderstorms could cause them to seriously malfunction and increase the risk of electric shock.

## BATTERY INFORMATION

- Your device is powered by rechargeable batteries.
- Unplug the charging case from the electrical plug when not in use.

- If left unused, a fully charged battery will lose its charge over time.
- We recommend that you fully charge your earbuds twice a month to ensure the battery's integrity.
- Please do not leave the device (and the charging case) in hot or cold places, such as inside a closed car in the summer or winter as this will reduce the capacity and life of the batteries.
- Batteries may also explode if damaged.
- Do not expose the batteries to fire as they may explode.

## **FCC STATEMENTS**

### **FCC Compliance Statement - Part 15**

This device complies with Part 15 of the FCC Rules. Operation is subject to the following two conditions:

1. This device may not cause harmful interference, and
2. This device must accept any interference received, including interference that may cause undesired

Any changes or modifications not expressly approved by the party responsible for compliance could void the user's authority to operate the equipment.

## **FCC Interference Statement - Part 15**

This equipment has been tested and found to comply with the limits for a Class B digital device, pursuant to Part 15 of the FCC Rules. These limits are designed to provide reasonable protection against harmful interference in a residential installation. This equipment generates, uses and can radiate radio frequency energy and, if not installed and used in accordance with the instructions, may cause harmful interference to radio communications. However, there is no guarantee that interference will not occur in a particular installation. If this equipment does cause harmful interference to radio or television reception, which can be determined by turning the equipment off and on, the user is encouraged to try to correct the interference by one of the following measures:

- Reorient or relocate the receiving antenna.
- Increase the separation between the equipment and receiver.
- Consult the dealer or an experienced radio/TV technician for help.

## **RF Exposure Information**

The device has been evaluated to meet general RF exposure requirement. The device can be used in portable exposure condition without restriction.

## RECYCLING

Your damaged or broken earphones can be recycled and we encourage you to do so to keep our planet clean. Where can you go to do this?

In the **US**, there are a couple of options:

<https://www.call2recycle.org>

<https://search.earth911.com>

<https://recyclenation.com/find>

<https://www.cta.tech/Consumer-Resources/Greener-Gadgets>

In **Canada**, please visit the links below:

<https://thinkreuse.net>

<https://www.call2recycle.ca>

In the **UK**, please visit the links below:

<https://www.recycle-more.co.uk/>

<https://www.recyclenow.com/local-recycling>

## SPECIFICATIONS

<b>Speaker unit:</b>	12 x 17mm, 16 $\Omega$
<b>Charging port:</b>	USB Type-C
<b>Dimensions:</b>	Earbuds: 47.5 x 36 x 21 mm / 1.87 x 1.41 x 0.82 in Case: 84 x 60 x 32mm / 3.3 x 2.36 x 1.26in
<b>Weight:</b>	Earbud: 9.1g / 0.32 oz / 0.02 lb Case: 56g / 1.97 oz / 0.12 lb

## THANK YOU

We truly appreciate that you chose **TREBLAB** as your trusted brand of translation earbuds. Our team sincerely hopes that you enjoy the great sound and seamless usability the **TREBLAB X-Smart** provides.

We love making our customers happy by providing true value with our products. If for any reason you are not completely satisfied with your purchase or have any questions, please let us know by contacting us at [http://treblab.com/contact\\_us](http://treblab.com/contact_us).

We care about our customers above all and are always here to serve you.





TREBLAB

## 1-YEAR LIMITED WARRANTY

Please visit [www.treblab.com](http://www.treblab.com) to register  
YOUR product.

Designed by Productech in the U.S.

Wireless Earbuds

# X-Smart



Made in China



WARNING: This product can expose you to Bisphenol A, which is known to the State of California to cause cancer. For more information, go to [www.P65Warnings.ca.gov](http://www.P65Warnings.ca.gov)